

天泰折叠式手推草坪机
(Fu款-谢明专用)

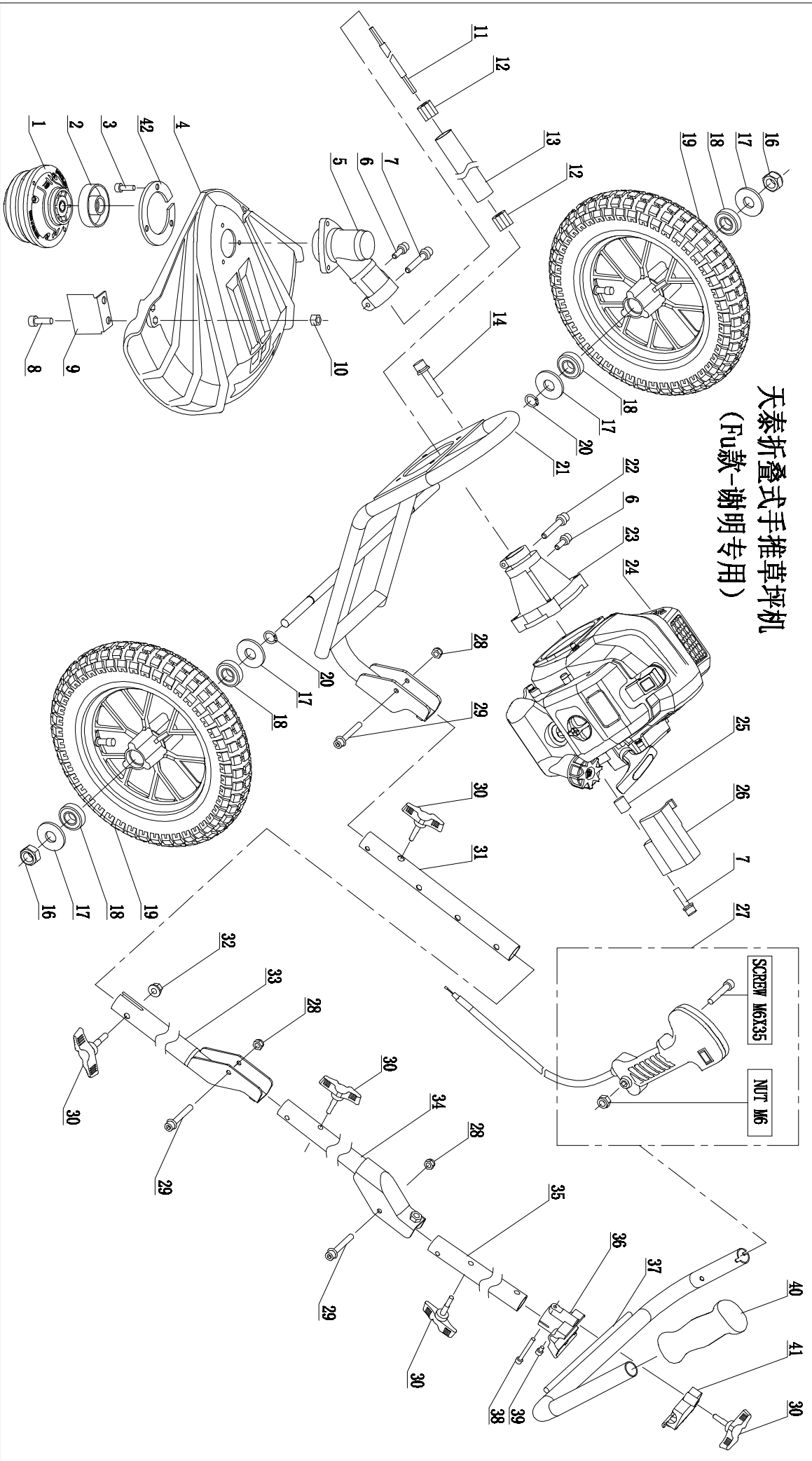

KEY	DESCRIPTION	QTY/ UNIT	KEY	DESCRIPTION	QTY/ UNIT	KEY	DESCRIPTION	QTY/ UNIT	KEY	DESCRIPTION	QTY/ UNIT
1	NYLON HEAD	1	9	SMALL BLADE 40x20x36	1	17	WASHER 12(ø13Kø22x2)	4	25	TUBE 5.218x7.5	1
2	DOWN HOLDER	1	10	NUT M5	2	18	BEARING 6001-27(ø12xø28x8)	4	26	DEFLECTOR	1
3	SCREW M5x14	3	11	SHAFT (8x355)	1	19	WHEEL ASSY (ø310)	2	27	RIGHT HANDLE (ø22)	1
4	SHIELD	1	12	OIL BEARING (ø8xø22x20)	2	20	SNAP RING 12	2	28	NUT M6	3
5	GEAR ASSY (ø26)	1	13	PIPE (ø26x325)	1	21	FRAME	1	29	COMBINATION SCREW M6x40	3
6	COMBINATION SCREW M5x12	2	14	COMBINATION SCREW M6x35	4	22	COMBINATION SCREW M6x30	1	30	SCREW KNOB M8x40	5
7	COMBINATION SCREW M5x25	2	15		23	HOUSING ASSY (ø26)	1	31	DOWN POLE A	1	
8	SCREW M5x20	2	16	NUT 12	2	24	ENGINE 52CC	1	32	NUT M8	1
									33	DOWN POLE B	1
									34	MIDDLE POLE	1
									35	UP POLE	1
									36	HANDLE BARNKET A	1
									37	HANDLE	1
									38	SCREW M5x40	1
									39	SCREW M5x6	1
									40	LEFT HANDLE (ø22)	1
									41	HANDLE BARNKET B	1
									42	COVER gear	1

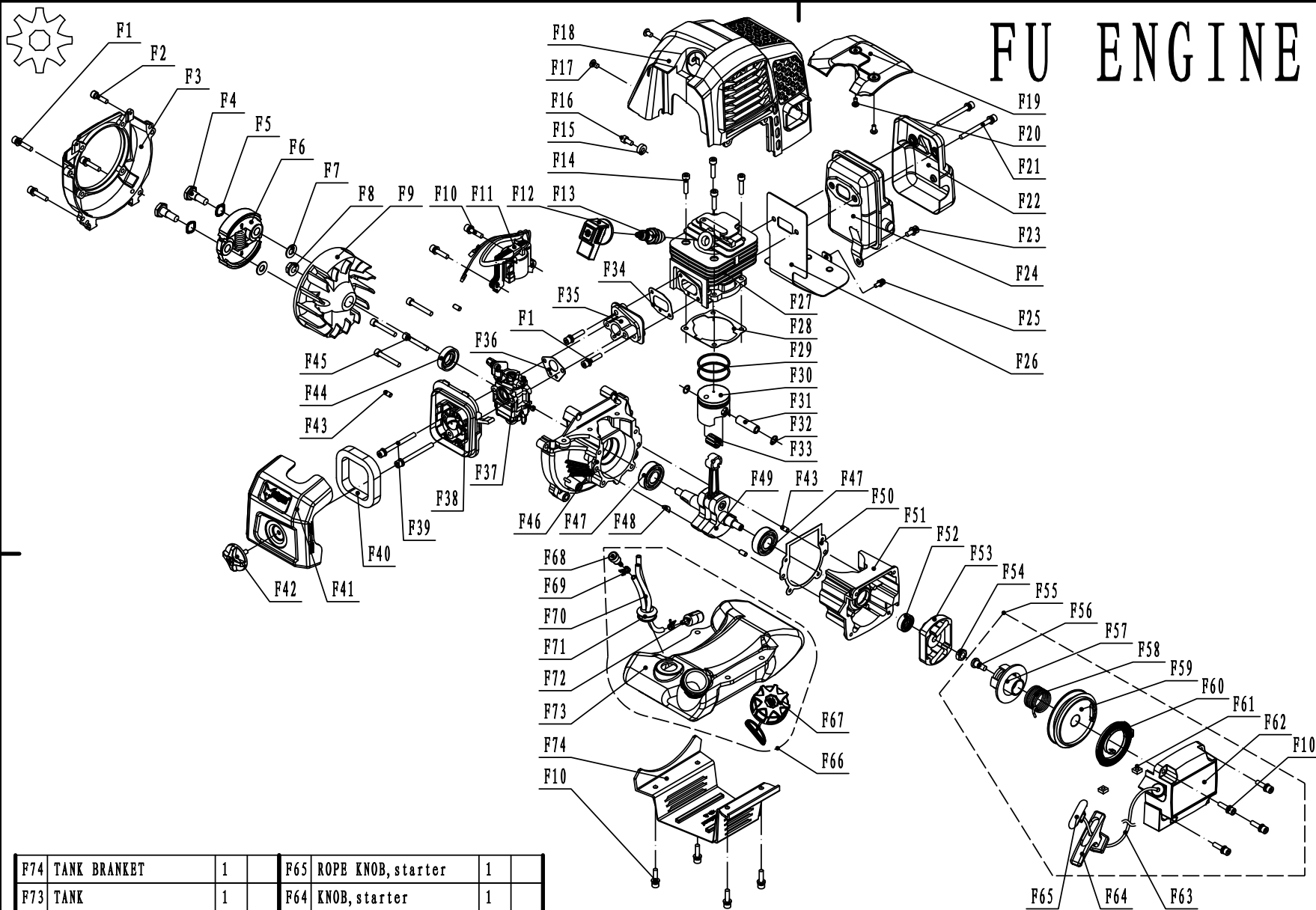

FU ENGINE

F74	TANK BRANKET	1	F65	ROPE KNOB, starter	1
F73	TANK	1	F64	KNOB, starter	1
F72	FUEL FILTER	1	F63	ROPE, starter	1
F71	FUEL PIPE SEAT	1	F62	COVER, starter	1
F70	FUEL PIPE	3	F61	SQUARE SCREW	2
F69	PIN	1	F60	COIL SPRING, starter	1
F68	BALANCER	1	F59	WHBEL, starter	1
F67	TANK CAP	1	F58	SPRING, starter	1
F66	FUEL TANK ASSY		F57	RATCHET, starter	1

F56	SCREW ST	1	F50	GASKET, crankcase	1	F44	OIL SEAL 10*30*7	1
F55	RECOIL STARTER ASSY		F49	CRANKSHAFT	1	F43	PIN $\Phi 5 \times 10$	4
F54	NUT M8	1	F48	KEY	1	F42	SCREW KNOB	1
F53	PULLEY	1	F47	BEARING 6202	2	F41	COVER, air filter	1
F52	OIL SEAL 12*22*7	1	F46	LEFT CRANKCASE	1	F40	FILTER ELEMNT	1
F51	RIGHT CRANKCASE	1	F45	BOLT M5*35	4	F39	BOLT M5*55	2

F38	BODY,air filter	1	
F37	CARBURETOR	1	
F36	GASKET,carburetor	1	
F35	INTAKE PIPE	1	
F34	GASKET,intake pipe	1	
F33	NEEDLE BEARING	1	
F32	PISTON SPRING	2	
F31	PISTON PIN	1	
F30	PISTON	1	
F29	PISTON RING	2	
F28	GASKET,cylinder	1	
F27	CYLINDER	1	
F26	GASKET,muffler	1	
F25	BOLT M4*14	1	
F24	MUFFLER	1	
F23	BOLT M5*10	1	
F22	MUFFLER HEAT MAT	1	
F21	BOLT M6*55	2	
F20	ST4*8	2	
F19	CYLINDER INNER COVER	1	
F18	CYLINDER COVER	1	
F17	SCREW M4*12	2	
F16	BOLT M5*10	1	
F15	HEAT MAT	1	
F14	BOLT M5*20	4	
F13	SPARK PLUG	1	
F12	IGNITION COIL CAP	1	
F11	IGNITION COIL	1	
F10	BOLT M5*20	10	
F9	FLYWHEEL	1	
F8	NUT M8	1	
F7	FLAT WASHER	2	
F6	CLUTCH	1	
F5	CURRUGATED WASHER	2	
F4	BOLT	2	
F3	SIDE COVER	1	
F2	BOLT M5X20	1	
F1	BOLT M5X25	3	
No.	Description	Qty	Note